

# DESCALER

To ensure the long life of your appliance, you are advised to regularly descale and clean the macerator and the toilet bowl.

This special sanitising cleaner and descaler is perfectly designed to descale your unit without harming any of the internal components.

Product Code: 1085

## 5 REASONS TO USE THE DESCALER:

- Specially designed to keep the rubber components intact
- A formula perfectly suited to small diameter pipework
- Product suitable for septic tanks
- Formula and dosage tested in laboratory
- Manufactured by Saniflo and is suitable for all our products



## HOW IS THE DESCALER USED?

**1** BEFORE USING THE DESCALER: **DISCONNECT THE ELECTRICITY SUPPLY TO THE MACERATOR.**



Put a dose of descaler in the bowl.



Leave at least 2 hours

**4** **RECONNECT THE ELECTRICITY SUPPLY TO THE MACERATOR.**



Rinse by activating the flush twice.

# SANIALARM®

Security, reassurance and peace of mind...

## A UNIQUE CONCEPT

Occasional power outages, scaling of poorly maintained old appliances or problems with clogged pipes, cause a variation in the level of water permanently contained in a macerator or a Saniflo pump.

To provide a solution to this situation, a Sanialarm will provide an instant alert enabling you to take immediate action.

Product Code: 1095

## HOW IT WORKS?

The alarm is fixed on the cover of the Saniflo device. It consists of a level pressure switch which automatically triggers the alarm when the water volume exceeds the maximum level allowed. The alarm then produces a sound until it is turned off and the problem solved.



*Fits several models of the range of Saniflo macerators (old and current) as well as the SANISPEED® + pump. The alarm works with 2 1.5V batteries (not supplied)*

## EASILY SET UP THE ALARM



Insert 2 standard 1.5v batteries (not supplied) in the case.



Drill a hole 10mm in diameter at the location indicated on the cover of the device.

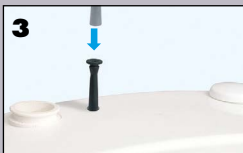

Coat with silicone grease before inserting the alarm pressure switch tube.



Fix the alarm in the opening of the tube.



Switch the alarm to the ON position.

BEFORE ANY HANDLING: **DISCONNECT THE ELECTRICITY SUPPLY TO THE MACERATOR.**